

KEY / LEGEND

- — — — Permit Parking Zone Boundary
- - - - - Estate Parking Boundary
- — — — Proposed At Any Time Waiting Restrictions
- — — — Existing Road Marking Removal
- — — — Existing Road Markings and Waiting Restrictions
- Proposed Sign on Lamp Column
- Existing Sign on Existing Post
- Proposed Sign on New Post
- Proposed Sign and Post to be Removed

Parking Bays

- ▬▬▬▬ Disabled Persons Parking Bay (Existing)
- ▤▤▤▤ Resident Parking Bay (No Road Markings)
- - - - - Proposed Parking Bay Marking

Parking Sign Plates

- EN Zone Entry Plate.
- EX Zone Exit Plate.
- CP3 Permit Parking Area Repeater Sign Plate
- DB Disabled Bay Sign

General Notes
CP3 Permit Parking Area to Operate Monday to Sunday At All Times (24/7)

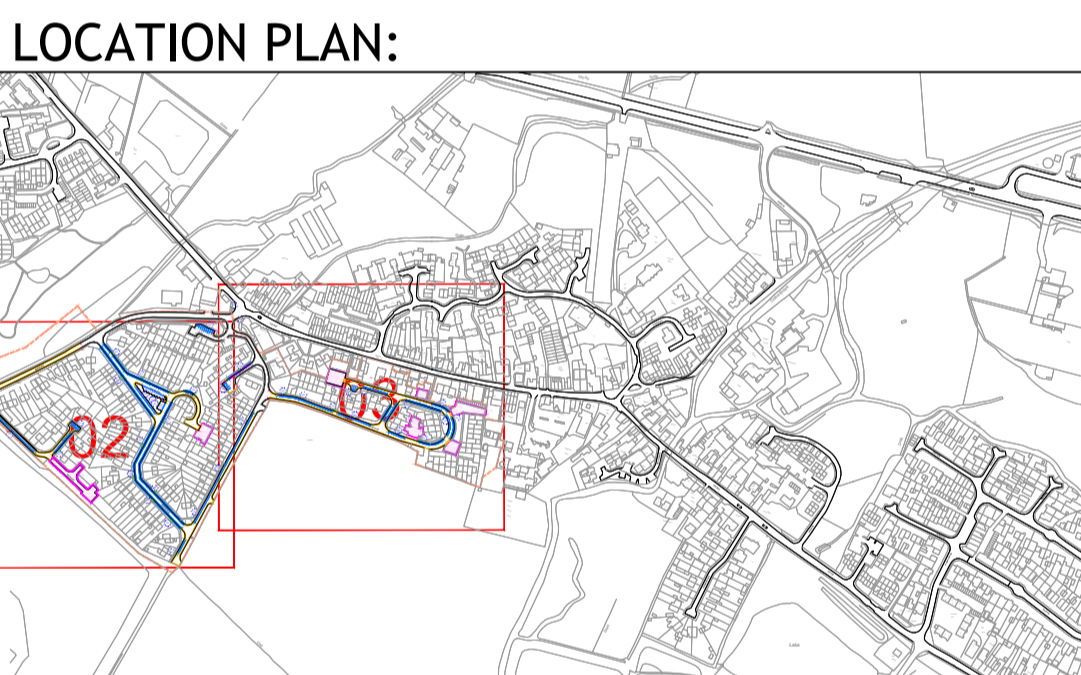

| Rev. | Date | Comments | Des | Chk | App |
|------|----------|--|-----|-----|-----|
| B | 15/05/25 | 1.2m min width - all footways where footway parking provided | AJB | | |
| A | 06/01/24 | DRAFT | AJB | | |

its intelligent transport services
 t +44 (0)20 3318 8560 e sales@its-global.co.uk

Client :
SLOUGH: PERMIT PARKING AREA

Title:
**CPZ - ID - CP3
 GENERAL ARRANGEMENT**

| | | |
|----------------------------|-----------------------|-----------|
| Drawing No. 49-1242-CP3 | Sheet No. 03 OF 04 | Rev. B |
|----------------------------|-----------------------|-----------|

1: 150@ A1

CAD REFERENCE: G:\Shared drives\Borough Council\09-1242-Borough CPZ\Acad\Drawing Sheets\1242-CPZ-CP3 - 1242-CP3-03 DATE: 31/08/2024