

NOTES: Based upon survey maps with the permission of the controller of Her Majesty's stationery office. © Crown Copyright.
 1. (c) Crown Copyright. All rights reserved. 2021. License number 0100031673
 2. All traffic management to comply with Chapter 8 or Safety at Street Works and Road Works (A code of Practice).

BILL OF QUANTITIES:

NO.	DESCRIPTION	QUANTITY	UNIT

SITE DETAILS:

	ROAD CLOSURE
---	--------------

A	FIRST ISSUE FOR APPROVAL	CF	14/02/24
REV	BY	DATE	

Chevron Traffic Management
 Knight House
 Arkwright Way
 Scunthorpe
 DN16 1AD
 T: 01652 656291

CLIENT:

 A LOXAM Company

TRAFFIC MANAGEMENT:
 Diversion

SITE LOCATION:
 Dolphin Road,
 Slough,
 SL1 1TA



Co-ordinates, Latitude - Longitude: 51.5095980, -0.578383		CLIENT REF: CSR042492	
DRAWN BY / DATE	CHECKED BY / DATE	APPROVED BY / DATE	
CF 14/02/24	AE 14/02/24	CH	14/02/24
SCALE @ A3: NTS		DRAWING NUMBER: CF2701	

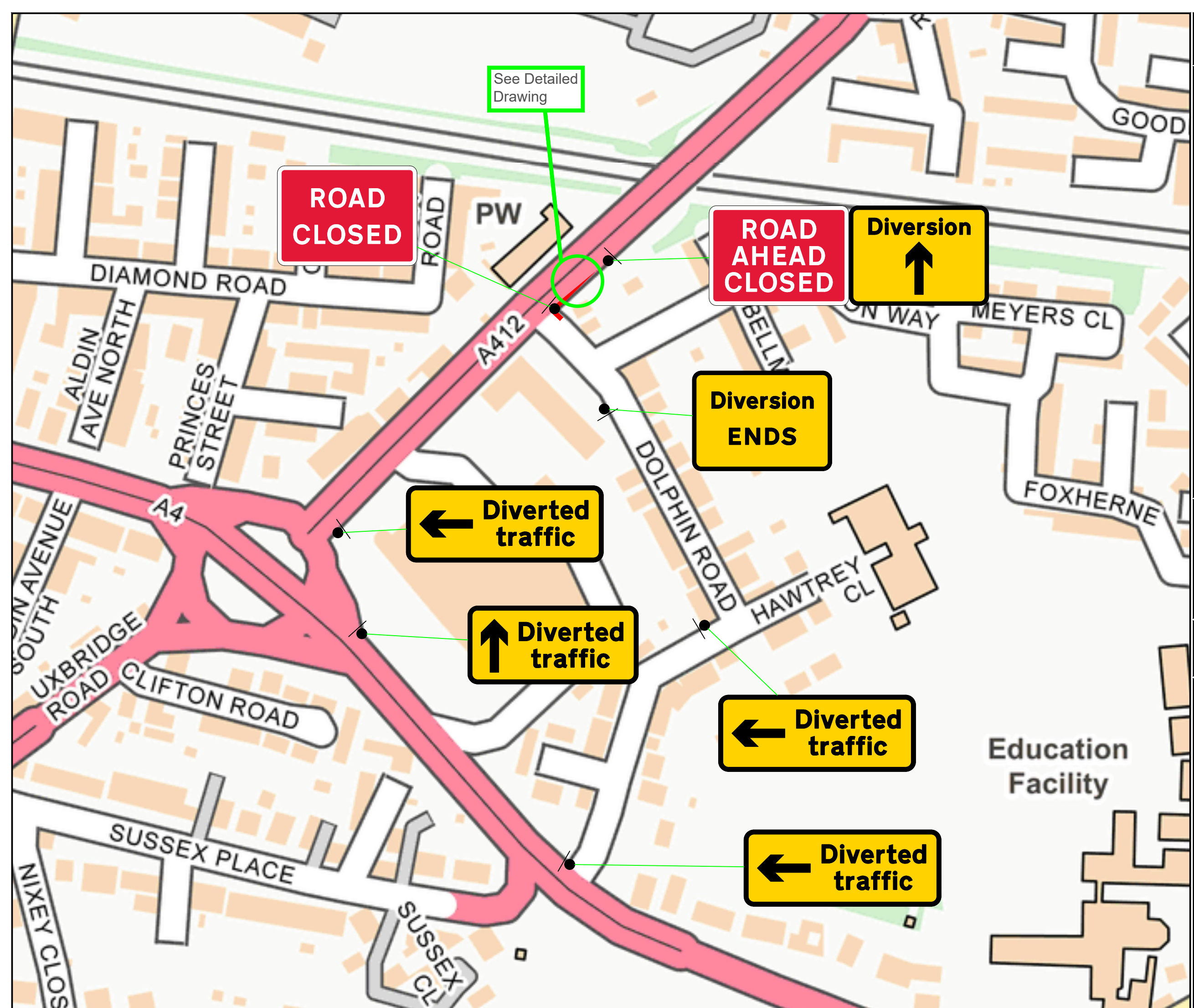

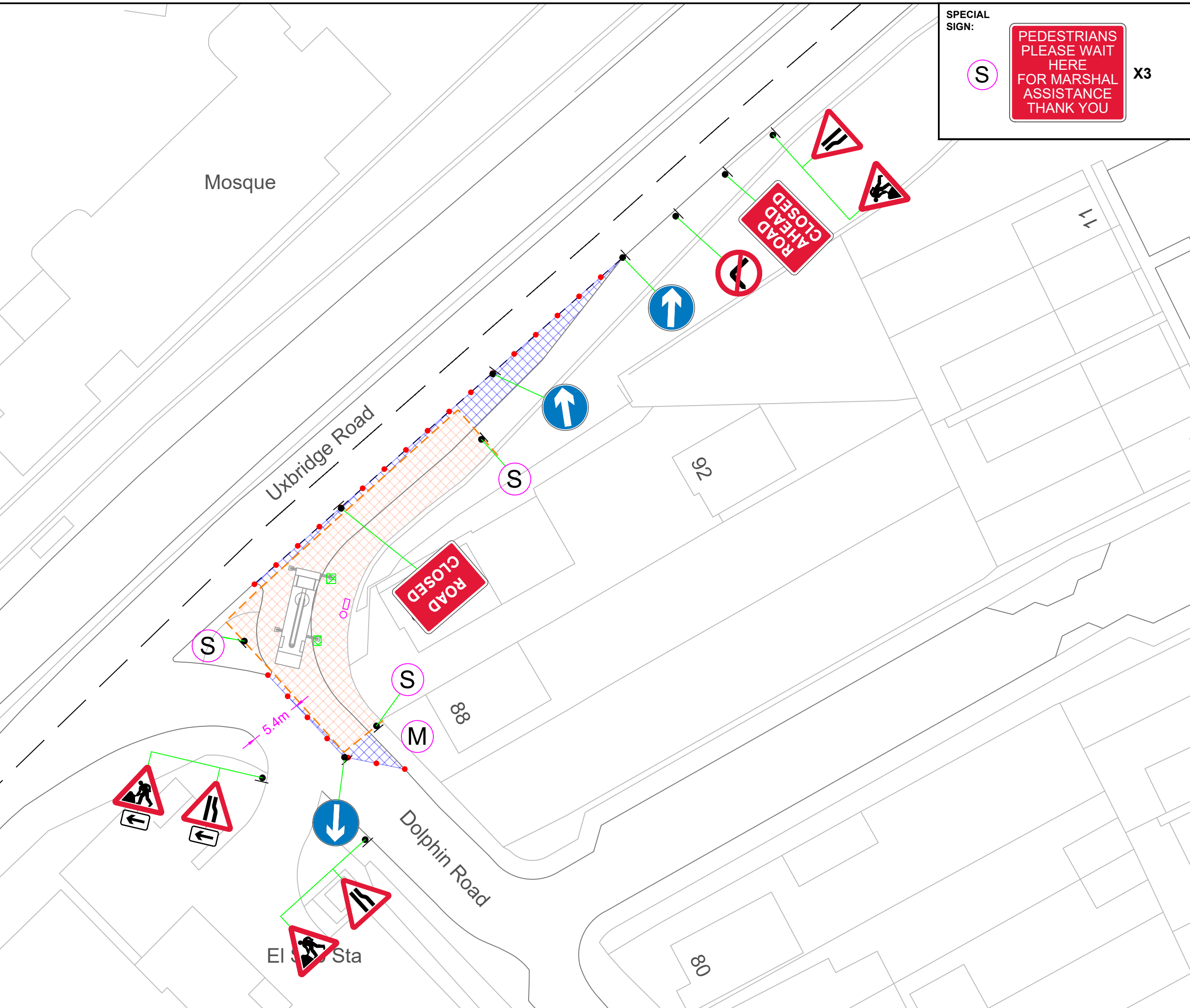

SPECIAL SIGN:

S

PEDESTRIANS PLEASE WAIT HERE FOR MARSHAL ASSISTANCE THANK YOU

X3

NOTES: Based upon survey maps with the permission of the controller of Her Majesty's stationery office. © Crown Copyright.
 1. (c) Crown Copyright. All rights reserved. 2021.License number 0100031673
 2. All traffic management to comply with Chapter 8 or Safety at Street Works and Road Works (A code of Practice).

BILL OF QUANTITIES:

SITE DETAILS:

	WORK AREA		SPEED LIMIT: 40
	SAFETY ZONE		RUNNING LANE: 3.0-3.5m
	PEDESTRIAN BARRIER		MAST
	CRANE MATS		MARSHAL

A	FIRST ISSUE FOR APPROVAL	CF	14/02/24
REV		BY	DATE

Chevron Traffic Management
 Knight House
 Arkwright Way
 Scunthorpe
 DN16 1AD
 T: 01652 656291

Nationwide Platforms
 A LOXAM Company

Traffic Management:
 Detailed Drawing

SITE LOCATION:
 Dolphin Road,
 Slough,
 SL1 1TA



Co-ordinates, Latitude - Longitude: 51.5095980, -0.578383		CLIENT REF: CSR042492	
DRAWN BY / DATE	CHECKED BY / DATE	APPROVED BY / DATE	
CF / 14/02/24	AE / 14/02/24	CH	14/02/24
SCALE @ A3: NTS		DRAWING NUMBER: CF2702	