

DIVERSION ROUTES

Court Crescent
Waterbeach Road
& Vice Versa

DIVERSION ROUTES

Court Crescent
Waterbeach Road
& Vice Versa

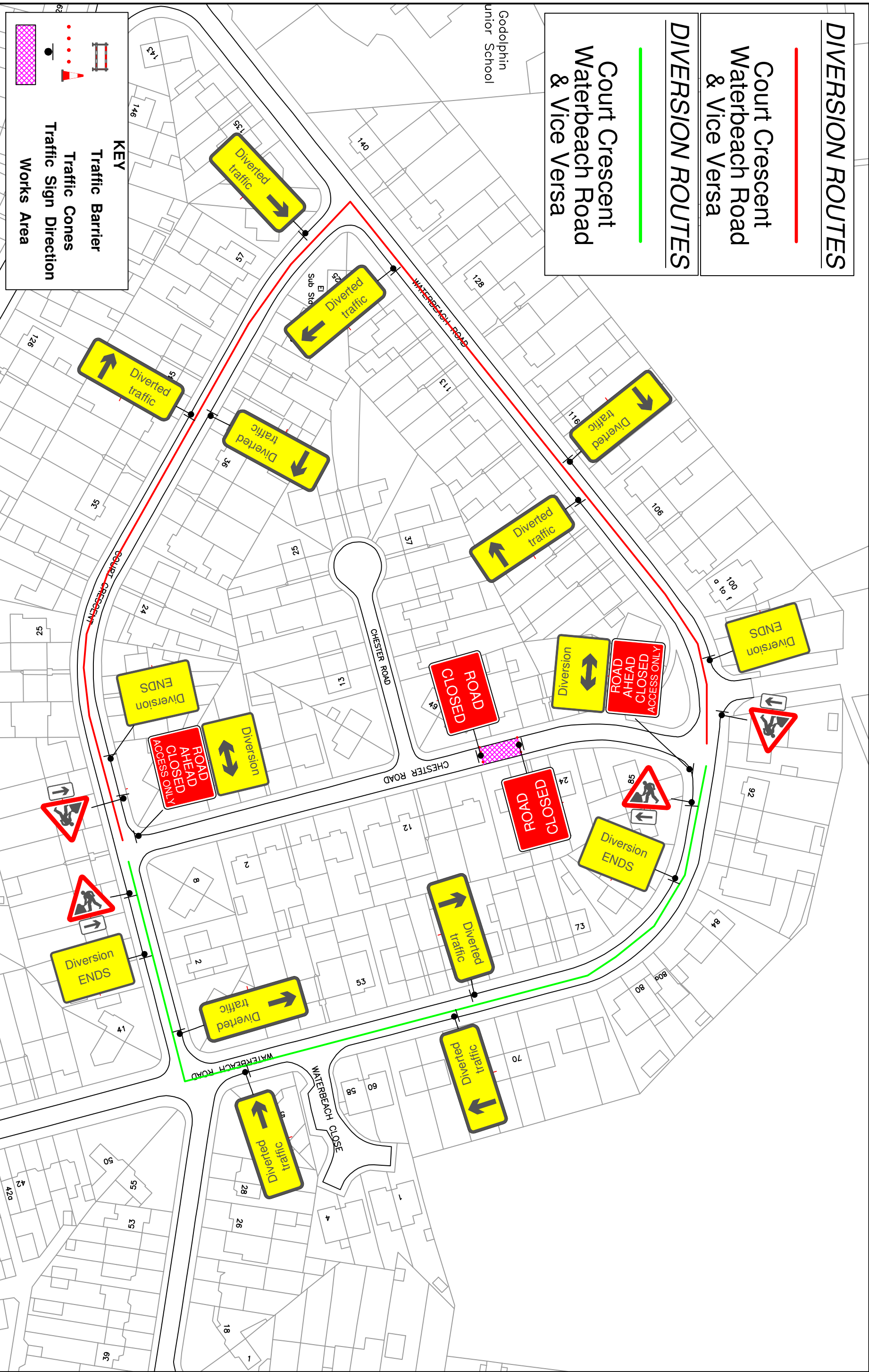

Godolphin Junior School

KEY

- Traffic Barrier
- Traffic Cones
- Traffic Sign Direction
- Works Area

CAPPAGH

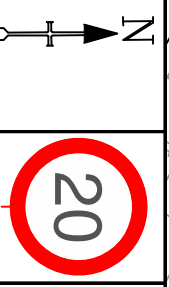

Chester Road,
Slough, SL1 3JS
Road Closure



Units 3, 4 & 5 River Moles Business Park
Mill Mead Road, Esher,
Surrey KT10 8BJ
Tel: 0800 6444 114
Web: www.tglgroup.co.uk
Email: tmdrawings@tglgroup.co.uk

- 1) TEMPORARY TRAFFIC MANAGEMENT TO BE SET OUT IN ACCORDANCE WITH CHAPTER 8 AND SAFE WORKING PRACTICES.
- 2) ALL BUS, PARKING AND LOADING BAYS SHOULD BE SUSPENDED WITH THE RELEVANT AUTHORITY PRIOR TO COMMENCEMENT OF WORK.
- 3) WORKS VEHICLES TO BE PARKED WITHIN WORKS AREA.

DATE DRAWN	02.02.24	Drawing No.	1182.85
DRAWN BY	TGL CL		
CHECKED BY	TGL LE		
SCALE	N.T.S.		