

Pedestrian footways affected by CH8 signage will maintain a walkway of 1.2 metres minimum.
Cones will be used with any signage that is placed in the carriageway and all signs will be suitably weighted.

Shuttle lane running will be a minimum of 3.25m metres

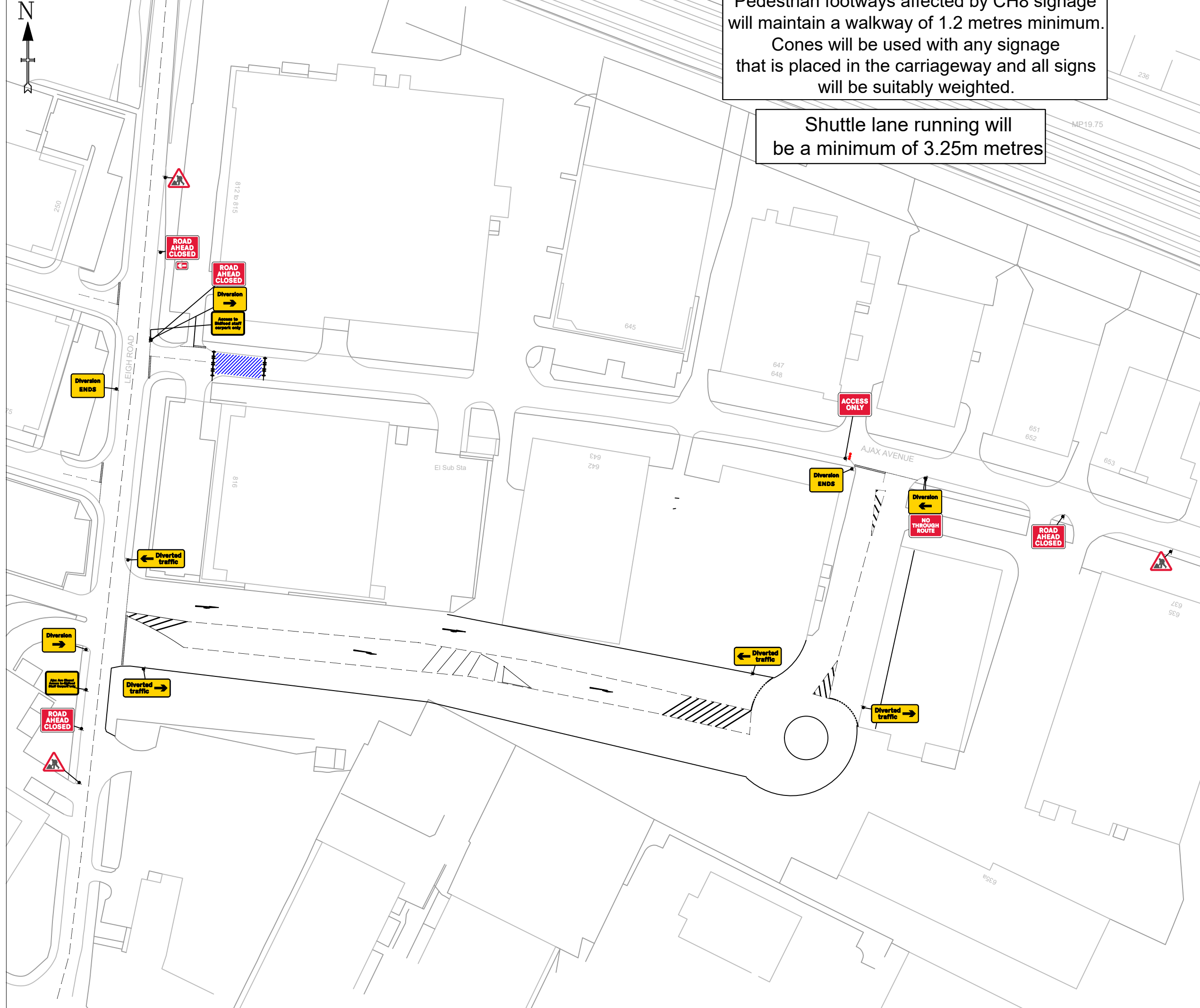

MARTIN H W Martin (Traffic Management) Ltd.
Head Office:
Fordbridge Lane
Blackwell
Arlerton
Derbyshire
DE55 5JY
Telephone: 01773 813213
Fax: 01773 813331
www.hwmartin.com

Member of the
TMCA
TRAFFIC MANAGEMENT
CONTRACTORS ASSOCIATION

AMBER LANGIS
UNIT 5&10 MILL PLACE
PLATT IND ESTATE
MAIDSTONE ROAD
SEVENOAKS
TN15 8FD
TEL: 01732 783980
FAX: 01732 780941
WEB: www.amberlangis.com

Additional Information:
All drawings are compliant with
Safety at Street Works
and Road Works
A Code of Practice

Drawing Keys:
KEY

- Traffic sign
- Traffic cone
- Traffic signals to Diagram 3000.1
- Working Space
- Safety Zone
- Pedestrian Barrier
- Welfare Unit

SAFETY ZONE DIMENSIONS (S)
Permanent speed limit 30mph or less
Sideways safety zone 0.5m
Longways safety zone 0.5m
(Dimensions are minima)

Client: **Adamson**

Type of works: **Road closure+ Diversion**

Title of Scheme/Project: **Water Network**

Name of drawing: **Ajax Ave Slough Water Network-2**

Speed limit of road:

Drawing Number: **Boro - AL 719**

Date Drawn: 30/06/23	Date Checked: 30/06/23	Date Approved: 30/06/23
Drawn by: Chris Finneran	Checked by: Colin Hardy	Approved by: Client

Current revision 1

See previous revisions below.

Rev	Details	Date
1	Tm Signage Added	30/06/23

Original Drawing size A3 Scale NTS

This drawing is the property of the H W Martin group of companies, no part of this drawing may be reproduced in any form without prior permission.